

**Specification Status: RELEASED**

**Max Electrical Rating at 20°C**

Operating Voltage: 250V<sub>DC</sub>  
Interrupt Current: 3A<sub>RMS</sub>

Fault Voltage: 600V<sub>RMS</sub>

Lead Material: 22 AWG Sn plated copper  
(0.65 mm [0.026"] nominal diameter)

External Coating Material: Cured, flame retardant epoxy polymer, meeting UL94 V-0 requirements.

Marking:

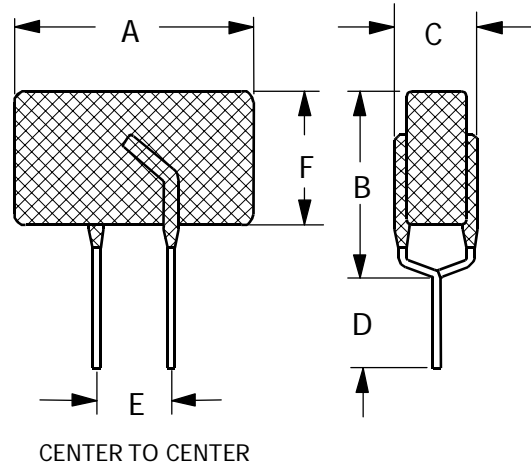
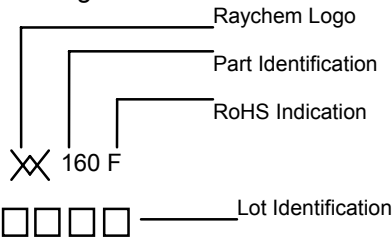

**TABLE I. DIMENSIONS:**

	A		B		C		D		E	F
	MIN	MAX	MIN	MAX	MIN	MAX	MIN	MAX	NOM	MAX
mm:	--	16.0	--	12.6	--	6.0	4.7	--	5.0	10.0
in:	--	(0.630)	--	(0.496)	--	(0.236)	(0.185)	--	(0.197)	(0.394)

**TABLE II. PERFORMANCE RATINGS @ 20°C (unless otherwise noted):**

I <sub>HOLD</sub> (A)	I <sub>TRIP</sub> (A)	RESISTANCE (Ω)			TIME TO TRIP (s) @ 1A	OPERATING TEMPERATURE (°C)	
		R MIN	R MAX	R <sub>1 MAX</sub> *		MIN	MAX
0.160	0.320	4.0	7.0	16.0	9.5	-40	85

\* Maximum device resistance @ 20°C measured 1 hour post trip.

Designed to assist equipment meet UL60950

Agency Recognition: UL, CSA  
Reference Documents: PS300  
Precedence: This specification takes precedence over documents referenced herein.  
Effectivity: Reference documents shall be the issue in effect on the date of invitation for bid.  
CAUTION: Operation beyond the rated voltage or current may result in rupture, electrical arcing or flame.

**Materials Information**

ROHS Compliant

ELV Compliant

Pb-Free

